

# Operator's Manual

## Universal Ear Piercing Instrument

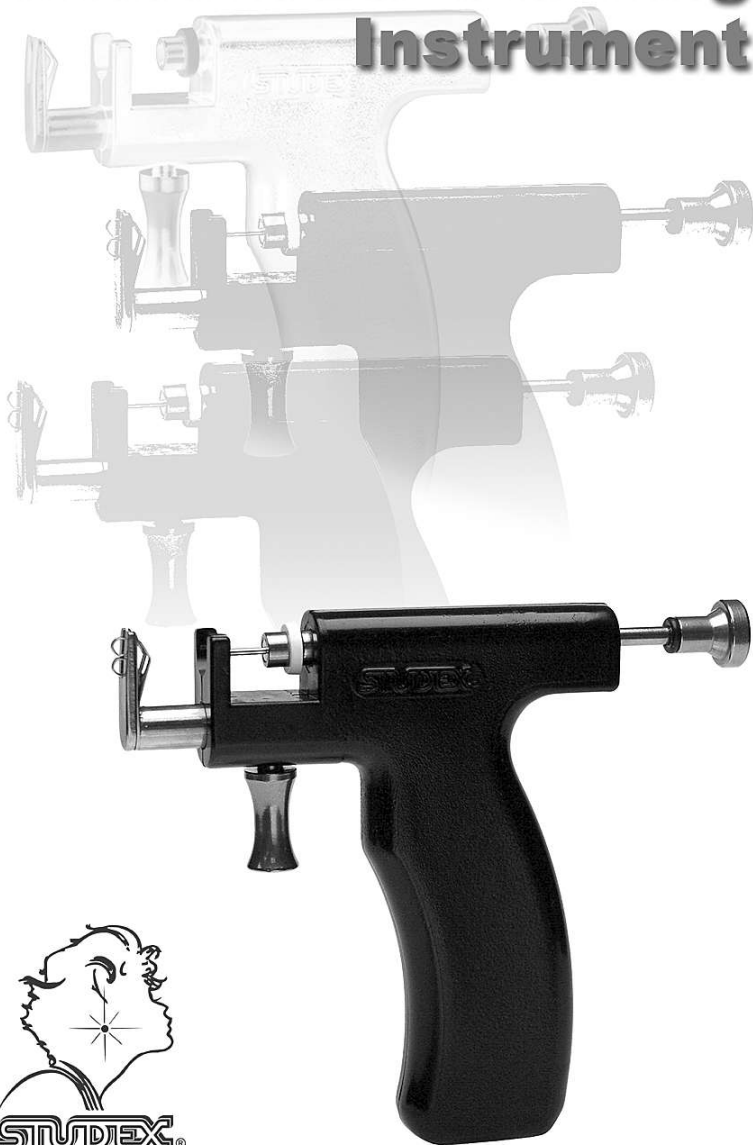

# CONGRATULATIONS!

You have purchased the finest ear piercing instrument available. Over three decades of design innovation and refinement have resulted in a piercing instrument that is easy to use, easy to load and easy to keep clean.

The contoured handle is made to fit the hand comfortably, producing a sure grip while piercing. The spring action plunger snaps the stud through the earlobe in 1/10th of a second and automatically installs the clasp properly, thereby reducing the possibility of discomfort and pinching.

When used with genuine STUDEX® sterile ear piercing studs and accessories, you are assured of years of trouble-free ear piercing.



# The Studex Universal Ear Piercing System

## Operating Instructions and Piercing Procedures

I.	Studex Background	2
II.	Advantages of the Studex Instrument	3
III.	Ear Piercing Instructions	
A.	Preparing the Customer	4
B.	Preparing Yourself	4
C.	Marking the Ears	4
D.	Loading and Piercing	
	1. Replacing Adapters	5
	2. Using the Studex Adapter Clip	6
	3. Loading the Instrument	7
	4. Piercing the Ear	8
IV.	After Piercing Care	10
V.	Troubleshooting	11

# STUDEX

For three decades, the STUDEX name has signified excellence in ear piercing instruments and studs around the world.

Onyx Industries, the parent corporation of STUDEX, is the world's largest manufacturer of ear piercing equipment and studs. Marketed worldwide, every item is made to the highest quality standards at Onyx Industries' own plant in Los Angeles, California, U.S.A.

Each stud starts with the finest U.S.-made medical grade stainless steel and is crafted using state-of-the-art automated Swiss high-precision machines. At every step of the manufacturing process, strict quality control is maintained, assuring you of the finest product available. Once completed, all ear piercing studs are packaged and sterilized using our validated sterilization management program and meet or exceed all international standards.

STUDEX products are tested and approved by health ministries internationally. And, because STUDEX is sold worldwide, you are assured of classic design, recognized around the world as the premier line of ear jewelry and piercing equipment available today.

STUDEX is constantly updating its products and packaging, working with an international network of distributors to provide marketing tools and merchandise that create demand at retail counters around the world.



# ADVANTAGES OF THE STUDEX UNIVERSAL SYSTEM

1. The Studex instrument has a built-in mechanism to easily release the stud adapter from the plunger. In addition, a set of color-coded Adapter Clips are included with the kit that ease installation and removal of adapters. See loading instructions for details.
2. The handle of the Studex instrument is contoured for a comfortable, balanced grip for maximum control. The instrument is designed to allow the technician to maintain better alignment with the ear for a more accurate piercing.
3. In the cocked position, the pointed tip of the piercing stud sits closer to the ear than with other instruments. This allows the technician to more precisely position the stud for a more accurate piercing.
4. Adapters are color-coded to differentiate between sizes.
5. The backing nuts (clasps) are located on the plastic mount under each piercing stud for easier insertion into the clasp retainer.

## Stud and Instrument Component Names

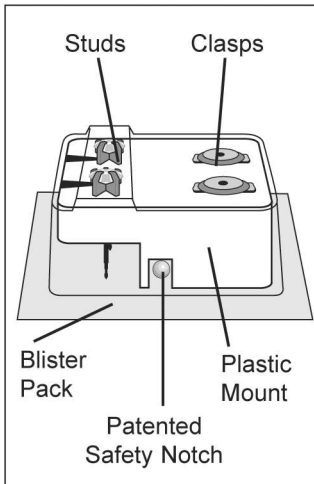

Figure 1

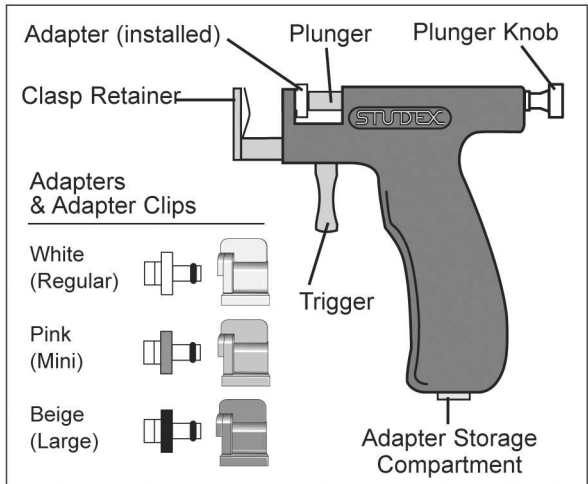

Figure 2

# EAR PIERCING INSTRUCTIONS

## Preparation for Piercing

### A. Preparing the Customer

1. Have the customer select the style of piercing stud they would like from the Studex Ear Piercing Selection display board.
2. Have the customer complete and sign the Release Form.
3. Have the customer sit in the designated piercing area.

### B. Preparing Yourself for the Ear Piercing

First, familiarize yourself with the piercing instrument and the packaged studs (see Figures 1 and 2). It is very important that you present yourself as a confident, expert ear piercer to the customer. The more comfortable you are, the more at ease your customer will be. This will help the customer relax and relieve any anxiety they might be experiencing.

1. Thoroughly clean both hands. Put disposable gloves on both hands **BEFORE** proceeding with the ear piercing.
2. Check customer's ears for cysts. When you pinch the ear and feel a small, hard lump that can be moved, it is probably a cyst. If you can see and feel a lump that doesn't move, it is most likely scar tissue (cysts are not visible and do not move). You may pierce through scar tissue, but never through a cyst, as it may rupture, releasing debris into the surrounding tissue, which can cause an infection.

### C. Marking the Ears

1. Have the customer take off any earrings they are wearing.
2. Cleanse the customer's ears with Sterile Prep Pad or cotton ball with alcohol and let dry.
3. Ask the customer where they would like the piercing to be and mark the ears accordingly with the non-toxic Marking Pen (See Figure 3).
4. Have the customer check and approve the marks **BEFORE** proceeding with the piercing. The customer should not touch their ears after cleansing.



Figure 3

# EAR PIERCING INSTRUCTIONS

## Replacing an Existing Adapter Without using the Studex Adapter Clip

1. When you first receive your instrument, the Regular adapter is already in the plunger of the instrument. If you are piercing with either a Mini or Large stud, you must remove the Regular adapter and install the proper adapter for the studs you are using. The Mini and Large adapters are stored in the handle of the instrument.
2. Hold the trigger in and pull the plunger all the way back past the cocked position, until the plunger cannot be pulled any farther. The adapter will dislodge itself from the plunger enough to be easily removed.
3. Select the proper adapter for the studs you will use to do the piercing. The adapters are color coded for ease of identification:

Regular  
White adapter



Mini  
Pink adapter



Large  
Beige adapter



4. With the plunger in the cocked position, press the desired adapter into the front of the plunger as far as it will go.
5. Once the adapter is properly seated in the plunger, pull the trigger to return the plunger to the uncocked position (Figure 4).

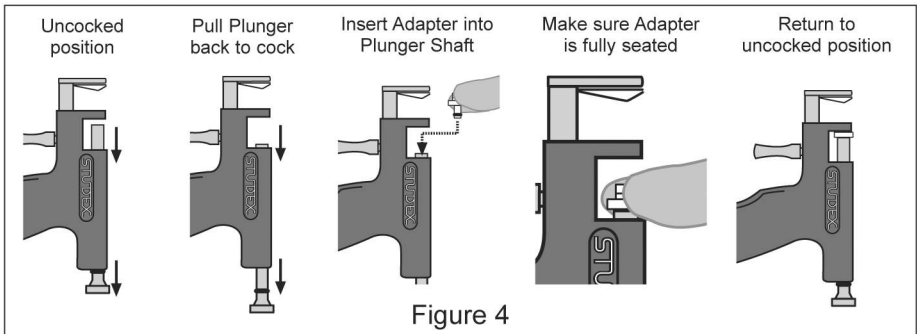

# EAR PIERCING INSTRUCTIONS

## Replacing the Stud Adapter Using the Studex Adapter Clip

Please read these instructions carefully before using the Adapter Clip to remove or install the stud adapter in order to prevent damage to the adapter, the clip or the instrument.

### Removing the Stud Adapter

1. Make sure the instrument is uncocked.
2. Place the empty Adapter Clip over the plunger as shown in Figure 5-1.
3. Pull the plunger knob back firmly (Fig. 5-2). The stud adapter will snap out of the plunger shaft automatically.
4. Lift the Adapter Clip off the instrument. The stud adapter will remain in the Adapter Clip (Fig. 5-3).

**HINT:** If you are using the Clips to store the adapters, be sure to match the color of the Clip to the color of the collar on the adapter. This will make identification of the proper stud adapter easier for the next piercing operation.

### Installing the Stud Adapter

1. Cock the instrument.
2. Snap the proper stud adapter into the Adapter Clip as shown in (Fig. 5-4).
3. Place the Adapter Clip (with the stud adapter in it) over the plunger as shown in (Fig. 5-5).
4. While holding the plunger knob firmly to keep the plunger from snapping forward, pull the trigger to release the plunger, and gently slide the plunger to the fully forward position (Fig. 5-6).

DO NOT simply pull the trigger and 'fire' the plunger, as damage to the adapter, clip or the instrument could result as the plunger snaps forward.

5. Once the plunger shaft is fully forward, lift off the Adapter Clip (Fig. 5-7)
6. Cock the instrument and press the stud adapter firmly to make sure it is fully seated in the shaft (Fig 5-8). The stud adapter will 'click' when it is properly seated.

Fig.  
5-1

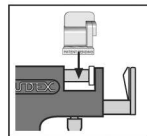

Fig.  
5-2



Fig.  
5-3

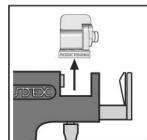

Fig.  
5-4

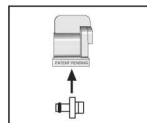

Fig.  
5-5

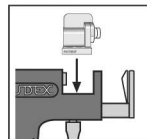

Fig.  
5-6

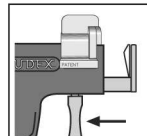

Fig.  
5-7

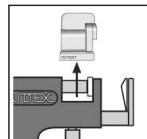
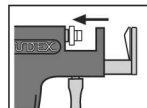

Fig.  
5-8





# EAR PIERCING INSTRUMENT

Cleanse this area thoroughly with alcohol Prep Pad before and after each piercing!

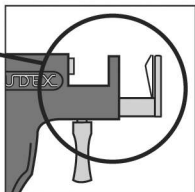

Figure 6

## Cleaning the Instrument

1. Before and after each piercing, thoroughly cleanse the entire area of the clasp retainer (see Fig. 6) by wiping with a cotton ball or swab moistened with alcohol.

## Loading the Instrument

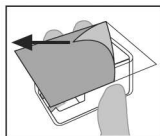

Figure 6-1

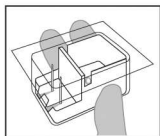

Figure 6-2

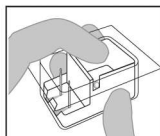

Figure 7-1

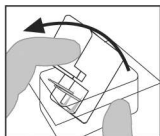

Figure 7-2

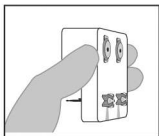

Figure 7-3

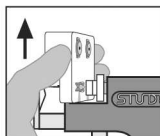

Figure 8

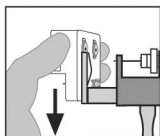

Figure 9

1. Cock the instrument by drawing the plunger back until it locks into place.
2. Grasp blister backing paper and peel away to expose the sterilized rigid plastic mount that holds the studs and clasps. **BE SURE NOT TO TOUCH THE STUDS** once the package is opened or the sterilization will be lost (Figures 6-1 & 6-2).
3. Being careful not to touch the studs, flip the plastic mount up with the index finger enough to grasp the sides of the mount with the thumb and middle finger (Figures 7-1 & 7-2). Lift the mount out of the sterile container. The studs should be at the bottom of the mount and the clasps at the top of the mount (Figure 7-3).
4. Insert one stud head into the stud adapter and pull the mount straight up to release the stud from the mount (Figure 8).
5. While keeping the instrument in the upright position, slide the corresponding clasp (located directly above the stud) into the clasp retainer at the end of the instrument (Figure 9).

# EAR PIERCING INSTRUCTIONS

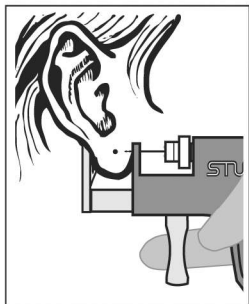

Figure 10

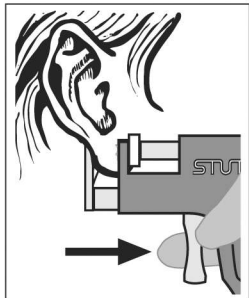

Figure 11

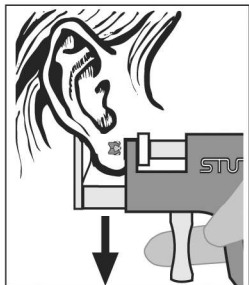

Figure 12

## Performing the Piercing

1. Place the ear between the clasp retainer and the stud, carefully aligning the point of the stud with the mark on the ear. While maintaining proper alignment, slowly squeeze the trigger until the ear is held securely by the instrument (Figure 10).
2. Keeping the proper alignment, continue to squeeze the trigger until it releases the plunger. In less than 1/10 of a second, the ear will be pierced and the clasp will be automatically installed on the stud with the proper spacing (Figure 11).
3. Release the trigger and carefully pull the instrument straight down from the ear (Figure 12).
4. Repeat this procedure for additional ear piercings.
5. Give the customer the signed after-piercing care instructions to take home with them.

**NOTE:** After you are finished piercing, ask the customer if they are OK to stand up, or if they need a few minutes. If the customer stands up and feels dizzy, help them sit down, and have them wait 3 to 5 minutes before leaving.

# EAR PIERCING INSTRUCTIONS

## Cartilage Piercing

If you are piercing in the cartilage area of the ear (see Fig. 13), special care must be taken during both the piercing and the after-piercing care.

When piercing the cartilage around the edge of the ear, with customers who have very thick or heavily curled cartilage, you must pull the cartilage slightly to “unroll” it. This is to ensure that the piercing instrument can be properly positioned.

Whenever piercing through the cartilage area of the ear, you must take care to ensure the instrument is held perpendicular to the surface of the ear.

Alert your client that the healing of the cartilage area will take somewhat longer than the lobe area.

Cartilage Area

Special care must be taken when piercing through this cartilage (dark area at right).

Do not pierce through the curled ‘edge’ of the ear.

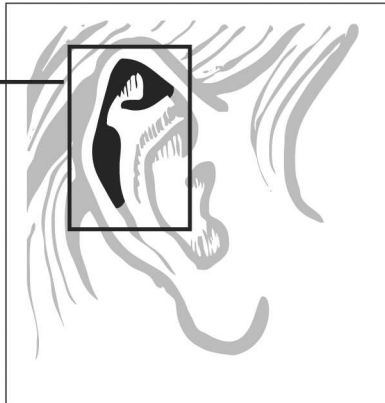

Figure 13

# AFTER PIERCING CARE

After piercing care is the most important factor in keeping pierced ears healthy.

STUDEX Ear Care Solution and STUDEX Ear Care Gel are formulated with the single purpose of maintaining healthy pierced ears.

STUDEX Ear Care Solution is specially formulated and pH balanced to keep the skin soft and healthy. STUDEX Ear Care Gel is the same basic formulation in a convenient gel form. Utilizing benzalkonium chloride, both Ear Care Solution and Ear Care Gel are effective against staph and strep germs. The non-burning formulation makes it safe and pleasant for all ages.

Training (piercing) studs should not be removed for 4 to 6 weeks. Clasps should not be too tight against lobe.

STUDEX Ear Care Solution or Gel should be used at least twice a day during the first 6 week healing process. Without removing the earrings, liberally apply Ear Care Solution or Gel to the front and back of each ear using a saturated cotton ball or tipped applicator. Gently slide studs back and forth in the ear to work the gel or solution into the pierced hole. Rotate ear studs (like winding a watch) two or three times a day.

Use Ear Care Gel before showering to keep hairspray, soap, shampoo and other hair preparations away from the ear. After showering or shampooing, the ears should be thoroughly rinsed and then cleansed with Ear Care Solution and Ear Care Gel should be re-applied.

Ear Care Solution or Gel should then be used daily thereafter to help reduce the incidence of infection. Even after the ears have healed and the customer is wearing other earrings, Ear Care Solution should be used regularly to keep ears healthy and earrings clean. Complete instructions for using Ear Care Gel and Ear Care Solution are on their containers and packaging.

Check studs for proper clearance

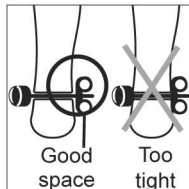

Apply Gel or Solution front & back

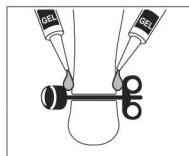

Slide Stud back & forth to work gel or solution into hole.

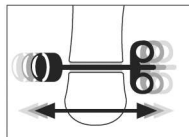

Apply Gel before showering to protect new piercing.

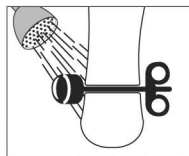

# TROUBLESHOOTING

The best way to be prepared for any problem that may occur during an ear piercing is to familiarize yourself with this section BEFORE it occurs. With a few simple steps, you will be prepared to handle almost any situation.

In normal operation, the stud is not released from the stud adapter unless the backing nut (clasp) has attached itself to the stud.

1. If the clasp does not attach and the stud remains in the adapter:
  - A. Hold the plunger all the way forward with your thumb firmly against and behind the plunger knob. This will prevent the plunger from moving.
  - B. Make sure the backing nut (clasp) is properly seated in the clasp retainer.
  - C. Squeeze the trigger all the way back until it stops.
  - D. Release the trigger.

This will normally cause the clasp to attach itself to the stud, and the stud will release from the instrument.

Continued next page

## TROUBLESHOOTING, continued

2. If the stud has not gone completely through the ear, or if the above procedure does not resolve the problem:
  - A. Saturate a cotton ball with Ear Care Solution.
  - B. Remove the stud and apply pressure on the pierced area with the cotton ball.
  - C. With a new pre-sterilized piercing stud, re-pierce through the same hole as the original piercing. Follow after-care procedures.

Note: If you must remove a stud and re-pierce with a new stud, be sure to wear disposable latex gloves and have cotton balls readily accessible. Dispose of used cotton balls, swabs and latex gloves appropriately after the piercing is complete. Any studs opened but not used also should be disposed of.



# Warranty

The STUDEX® Universal Piercing Instrument is backed by a two years guarantee to the original purchaser.

This instrument is made in the U.S.A. with highest quality materials and workmanship, and is fully inspected and tested before it leaves our plant.

If you ever have any problem with this instrument or any questions regarding its use, please call STUDEX toll-free at

1.800.478.8339

This guarantee is void if the instrument is misused or dropped, or is used with anything other than genuine STUDEX® Sterile Ear Piercing Studs.

# Universal System Warranty Registration Card

IMPORTANT: Fill out and mail within 10 days of purchase.

BUYER'S NAME \_\_\_\_\_

STORE NAME \_\_\_\_\_

ADDRESS \_\_\_\_\_

CITY \_\_\_\_\_ STATE \_\_\_\_\_ ZIP \_\_\_\_\_

TELEPHONE ( \_\_\_\_\_ ) \_\_\_\_\_

PURCHASE DATE \_\_\_\_\_ PURCHASE PRICE \_\_\_\_\_

PURCHASED FROM: \_\_\_\_\_

YOUR E-MAIL ADDRESS: \_\_\_\_\_

Suggestions or Comments: \_\_\_\_\_

\_\_\_\_\_





521 West Rosecrans Avenue  
Gardena, CA 90248-1514 • U.S.A.  
1.800.478-8339; 310.851.9300 • Fax: 310.851.9400  
[www.studex.com](http://www.studex.com) • [sales@studex.com](mailto:sales@studex.com)

© STUDEX • Reproduction without authorization is prohibited.

[artstudio@studex](mailto:artstudio@studex)